

## L100P Aluma-reel Remote Welder Control

AlumaReel mobile welding remote power and amperage control module are heavy duty, high quality and easy offer remote control of your welder settings. Remotes are designed to make the job easier. AlumaReel reel remotes are of a high-quality design. All AlumaReel reel remotes are designed and built to keep your equipment running and secure.

### Description

- An engineered poly construction - Quality solution for mobile welding
- Easy magnetic mounting and duplex 120V receptacles
- Quick connect and can be used with multiple brand and model welders
- Amperage and voltage control knobs - 6 pin interface (potentiometer)
- Optional Extension cables available (REXC50 = 50ft and REXC100 = 100ft)
- Certified to SCC Standards

Part Number	Part No. Box Only	Welder	Welder Models	Volts/Amperage/Frequency	Cable (ft)	Cable Size
L100P	LPBO	Lincoln	Ranger 250 - Ranger 305 - Vantage 300 Vantage 400 - Vantage 500	120/15/60Hz Potentiometer	100	16/6 SOOW
L100R	LRBO	Lincoln	Big Blue 300 - Big Blue 350 - Big Blue 400 Maxstar 350/700 - Pipe Pro 304 - Trailblazer 275/302	120/15/60Hz Rheostat	100	16/6 SOOW
M100P	MPBO	Miller	Classic 300 - SAE-300 - SAE-500	120/15/60Hz Potentiometer	100	16/6 SOOW



LPBO



## RSL Series - Security Cover Reel Lock Poly - AlumaReel

AlumaReel reel cover locks are heavy duty, high quality and offer easy install and removal from reels. Covers can be mounted on any series reel of its size. AlumaReel reel covers are of a molded and snug fit design. All AlumaReel reel covers are designed and built to keep your equipment organized and secure.

### Description

- An engineered poly construction - Lightweight design
- Stainless steel hardware - Padlock included with lock

Part Number	Application	Lock Type	Weight Specs	Reel Size
PRSL-12	Reel Cover	Twist	1	N/A



## MR Series Mounting Brackets

MR Series mounting brackets for AlumaReels are heavy duty and offer easy mounting for mounting reels. All MR mounting brackets are designed and built to keep your equipment running and secure.

### Description

- An engineered steel construction
- Powder coated finish

Part Number	Description	Height (in)	Mounting Hole Size	Bolts Count																																		
MR510-10	Corner Mount Single		3/8	6																																		
MR520-12	Bed Mount with 6" x 6" x 1/2" Plate	12	1/2	4																																		
MR520-24	Bed Mount with 6" x 6" x 1/2" Plate	24	4	MR520-36	Bed Mount with 6" x 6" x 1/2" Plate	36	1/2	4	MR520-48	Bed Mount with 6" x 6" x 1/2" Plate	48	1/2	4	MR540-24	Top/Bottom Mount with 4" x 6" x 1/4" Plate	24	1/2	4	MR540-36	Top/Bottom Mount with 4" x 6" x 1/4" Plate	36	1/2	4	MR540-48	Top/Bottom Mount with 4" x 6" x 1/4" Plate	48	1/2	4	MR540-60	Top/Bottom Mount with 4" x 6" x 1/4" Plate	60	1/2	4	MR540-72	Top/Bottom Mount with 4" x 6" x 1/4" Plate	72	1/2	4
MR520-36	Bed Mount with 6" x 6" x 1/2" Plate	36	1/2	4																																		
MR520-48	Bed Mount with 6" x 6" x 1/2" Plate	48	1/2	4																																		
MR540-24	Top/Bottom Mount with 4" x 6" x 1/4" Plate	24	1/2	4																																		
MR540-36	Top/Bottom Mount with 4" x 6" x 1/4" Plate	36	1/2	4																																		
MR540-48	Top/Bottom Mount with 4" x 6" x 1/4" Plate	48	1/2	4																																		
MR540-60	Top/Bottom Mount with 4" x 6" x 1/4" Plate	60	1/2	4																																		
MR540-72	Top/Bottom Mount with 4" x 6" x 1/4" Plate	72	1/2	4																																		

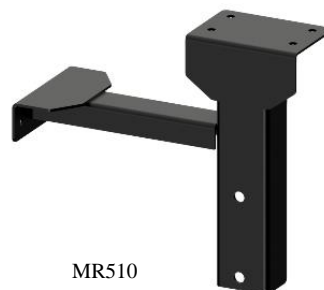
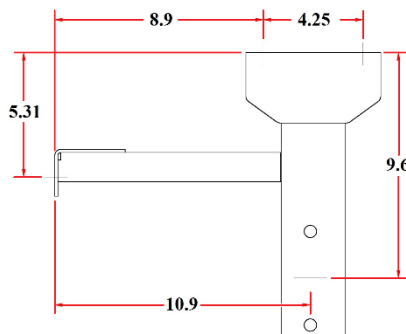

MR510

MR520

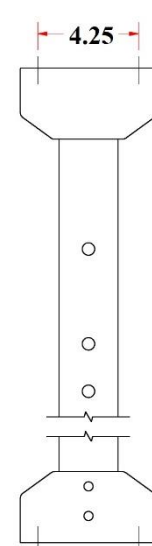
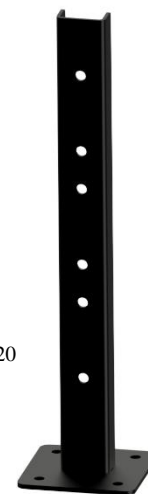

MR540

